

THE INFORMATION CONTAINED IN THIS DRAWING IS THE SOLE PROPERTY OF L-COM, INC. ANY REPRODUCTION IN PART OR WHOLE WITHOUT THE WRITTEN PERMISSION OF L-COM, INC. IS PROHIBITED.

REVISIONS			
REV	DESCRIPTION	DATE	APPROVED
A	INITIAL RELEASE	04/10/03	MCCORMICK

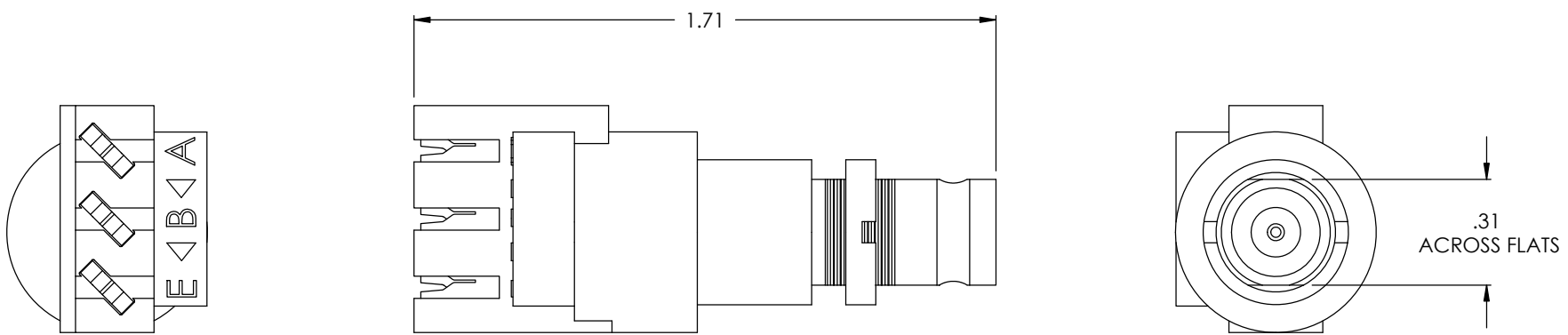

1.6/5.6 JACK

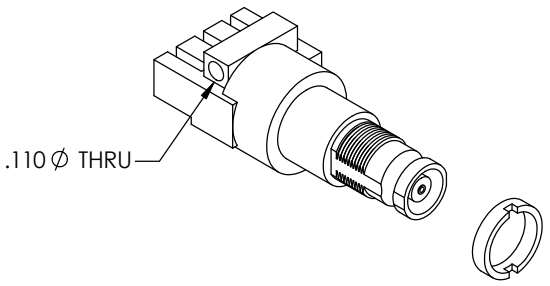

SPECIFICATIONS;

MATERIALS;
 BODY: BRASS
 INNER CONTACT: PHOSPHORUS BRONZE
 INSULATOR: PTFE
 OUTER SLEEVE & BASE MOLDING: NORYL BLACK
 IDC MOLDING: POLYESTER WHITE

FINISH;
 BODY: NICKEL PLATE
 CONTACT: GOLD PLATE
 IDC CONTACTS: SILVER PLATE

ELECTRICAL;
 CHARACTERISTIC IMPEDANCE: 75 OHM UNBALANCED
 COAXIAL TO 120 OHM BALANCED TWISTED PAIR

ENVIRONMENTAL;
 OPERATING TEMPERATURE RANGE: -30°C TO 75°C

APPLICATION NOTES:
 0.015" TO 0.026" CONDUCTOR DIAMETER, INSULATION
 DIAMETER 0.028" TO 0.56"

UNLESS OTHERWISE SPECIFIED, DIMENSIONS ARE IN INCHES [mm] OVERALL CABLE LENGTH TOLERANCE: ≤12 [305] = +1 [25] / -0 >12 [305] ≤60 [1524] = +2 [51] / -0 >60 [1524] ≤120 [3048] = +4 [102] / -0 >120 [3048] ≤300 [7620] = +6 [152] / -0 >300 [7620] = +5% / -0%	APPROVALS	DATE		50 HIGH STREET NORTH ANDOVER, MA 01845
	DRAWN BY C.MCCORMICK	04/10/2003		CATEGORY COAXIAL
ALL OTHER DIMENSIONAL TOLERANCES: .X = ± .2 [5.08] .XX = ± .02 [1.51] .XXX = ±.005 [1.13]	CHECKED BY D.PARHAM	04/10/2003	PRODUCT DESCRIPTION 1.6/5.6 JACK TO 3 POLE IDC	
	APPROVED BY R.CARRICK	04/10/2003	SIZE A	FSCM NO. 43321
PROJECTION 	CONFIGURATION DETAILS OF UNDIMENSIONED FEATURES MAY VARY		DWG. NO. ACK3010	REV. A
COLOR VARIATIONS MAY OCCUR		SCALE: NONE		CAD FILE: ACK3010.SLDDRW
				SHEET 1 OF 1