

THE INFORMATION CONTAINED IN THIS DRAWING IS THE SOLE PROPERTY OF L-COM, INC. ANY REPRODUCTION IN PART OR WHOLE WITHOUT THE WRITTEN PERMISSION OF L-COM, INC. IS PROHIBITED.

REVISIONS			
REV	DESCRIPTION	DATE	APPROVED
C	ECN 4709: UPDATED DRAWING AND NEW FORMAT	5/4/10	D.FRISIELLO
D	ECN 4752: REVISED FREQUENCY RANGE TO 6 GHz	5/19/10	D.FRISIELLO

DESCRIPTION	MATERIAL	FINISH
BODY	BRASS	NICKEL PLATE
DIELECTRIC	TFE	-
CENTER PIN	BRASS	GOLD PLATE
RETAINING RING	BRASS	NICKEL PLATE
GASKET	RUBBER	-
FERRULE	BRASS	NICKEL PLATE
SCREW CAP	BRASS	NICKEL PLATE

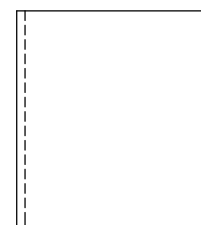
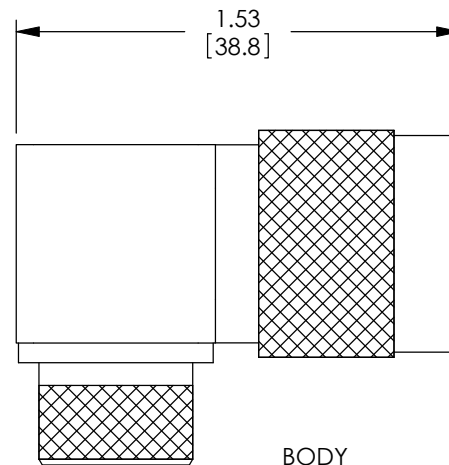
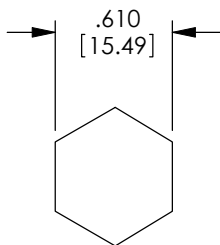
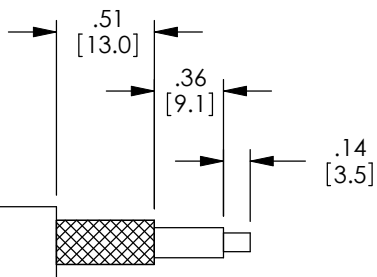

NOTES:

ELECTRICAL:  
 IMPEDANCE: 50 OHM  
 FREQUENCY RANGE: DC ~ 6 GHz  
 VOLTAGE RATING: 1500 VOLTS PEAK  
 DIELECTRIC WITHSTANDING VOLTAGE: 2500 VOLTS RMS

PACKAGING:  
 COMPONENT SHALL BE PACKAGED IN QUANTITY OF 10 IN ACCORDANCE WITH L-COM SPECIFICATION PS-0031.

MISCELLANEOUS:  
 CABLE RETENTION: 80 LBS. PULL.  
 APPLICATION: LMR600, AND EQUIVALENT.  
 ALL DIMENSIONS ARE FOR REFERENCE ONLY.

RoHS Compliant ✓

UNLESS OTHERWISE SPECIFIED, DIMENSIONS ARE IN INCHES [mm] OVERALL CABLE LENGTH TOLERANCE: ≤12 [305] = +1 [25] / -0 >12 [305] ≤60 [1524] = +2 [51] / -0 >60 [1524] ≤120 [3048] = +4 [102] / -0 >120 [3048] ≤300 [7620] = +6 [152] / -0 >300 [7620] = +3% / -0%	APPROVALS	DATE		45 BEECHWOOD DRIVE NORTH ANDOVER, MA 01845
	DRAWN BY D.FRISIELLO	5/4/10		CATEGORY
ALL OTHER DIMENSIONAL TOLERANCES: .X = ±.2 .XX = ±.02 .XXX = ±.005	CHECKED BY K.BURGNER	5/4/10	PRODUCT DESCRIPTION	
PROJECTION 	APPROVED BY K.BURGNER	5/4/10	CON, N-MALE R/A CRIMP LMR600	
	CONFIGURATION DETAILS OF UNDIMENSIONED FEATURES MAY VARY		SIZE <b>A</b>	FSCM NO. <b>43321</b>
	COLOR VARIATIONS MAY OCCUR		DWG. NO. <b>ANM-1616</b>	REV. <b>D</b>
			SCALE: NONE	CAD FILE: ANM-1616.SLDDRW
				SHEET 1 OF 1