

THE INFORMATION CONTAINED IN THIS DRAWING IS THE SOLE PROPERTY OF L-COM, INC. ANY REPRODUCTION IN PART OR WHOLE WITHOUT THE WRITTEN PERMISSION OF L-COM, INC. IS PROHIBITED.

REVISIONS			
REV	DESCRIPTION	DATE	APPROVED
A	INITIAL RELEASE	12/29/10	D.GRIFFIN

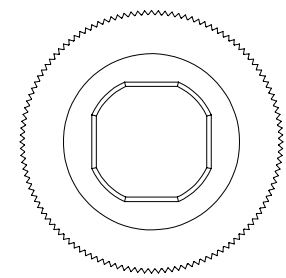
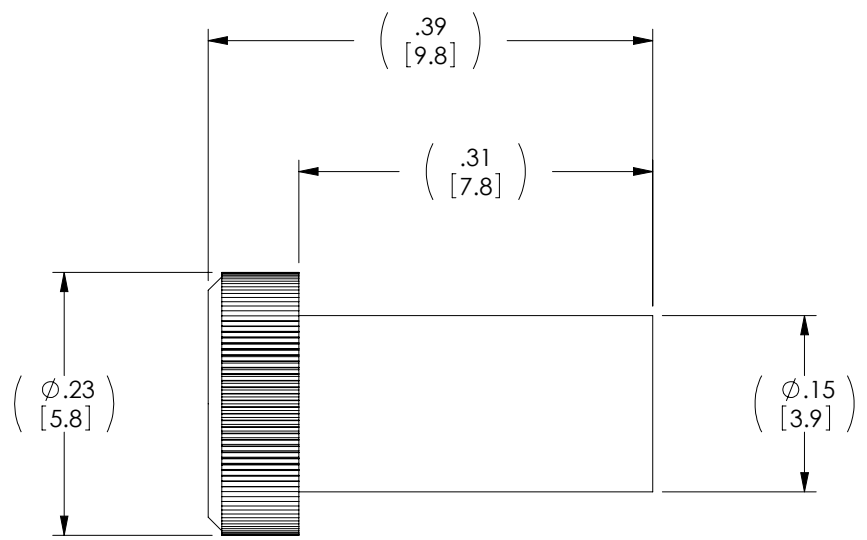

**NOTES:**

1. MATERIAL: CLEAR PLASTIC.
2. CAN BE USED WITH ST, SC and FC STYLE CONNECTORS.
3. DUST CAPS ARE TO BE PACKAGED 100 PIECES PER BAG IN ACCORDANCE WITH L-COM SPEC. PS-0031.

UNLESS OTHERWISE SPECIFIED, DIMENSIONS ARE IN INCHES [mm] OVERALL CABLE LENGTH TOLERANCE: $\leq 12$ [305] = +1 [25] / -0 $> 12$ [305] $\leq 60$ [1524] = +2 [51] / -0 $> 60$ [1524] $\leq 120$ [3048] = +4 [102] / -0 $> 120$ [3048] $\leq 300$ [7620] = +6 [152] / -0 $> 300$ [7620] = +3% / -0% ALL OTHER DIMENSIONAL TOLERANCES: .X = $\pm .2$ .XX = $\pm .02$ .XXX = $\pm .005$	APPROVALS DRAWN BY D. CASTRO CHECKED BY D. PARHAM APPROVED BY D. GALLAGHER	DATE 12/29/10 12/29/10 12/29/10	45 BEECHWOOD DRIVE NORTH ANDOVER, MA 01845		
	CONFIGURATION DETAILS OF UNDIMENSIONED FEATURES MAY VARY	CATEGORY FIBER		PRODUCT DESCRIPTION FIBER DUST CAPS 2.5MM PKG 100	
PROJECTION 	COLOR VARIATIONS MAY OCCUR	SIZE <b>A</b>	FSCM NO. <b>43321</b>	DWG. NO. DSTCP-C-25MM	REV. <b>A</b>
SCALE: NONE		CAD FILE: DSTCP-C-25MM.SLDDRW		SHEET 1 OF 1	