

THE INFORMATION CONTAINED IN THIS DRAWING IS THE SOLE PROPERTY OF L-COM, INC. ANY REPRODUCTION IN PART OR WHOLE WITHOUT THE WRITTEN PERMISSION OF L-COM, INC. IS PROHIBITED.

REVISIONS			
REV	DESCRIPTION	DATE	APPROVED
A	DRAWING REPLACES EC503-6E-OD1	6/26/14	D.FRISIELLO

WIRING CHART		
PLUG	JACK A	JACK B
1	1	1
2	2	2
3	3	3
4	4	4
5	5	5
6	6	6

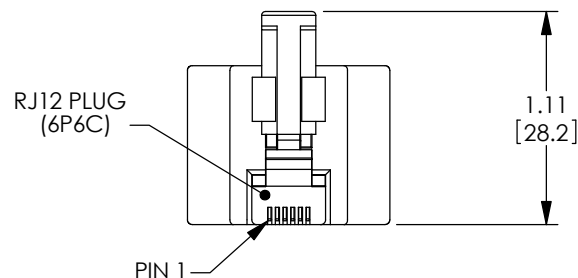
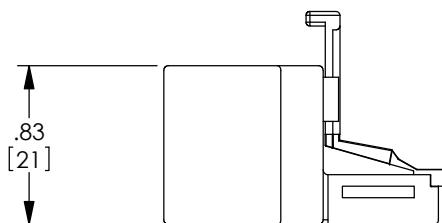
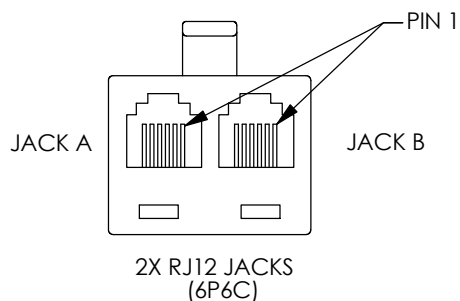
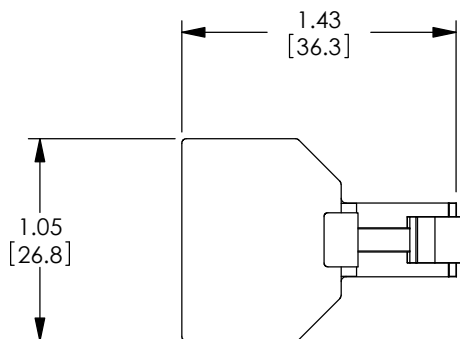

NOTES:

- JACKS ACCEPT RJ12 PLUGS.
- MATERIAL:
CONTACTS: GOLD PLATED
HOUSING: ABS; COLOR: IVORY
- ALL DIMENSIONS ARE FOR REFERENCE ONLY.
- COMPONENT SHALL BE TESTED FOR CONTINUITY.
- COMPONENT SHALL BE INDIVIDUALLY PACKAGED IN ACCORDANCE WITH L-COM SPECIFICATION PS-0031.

REGULATORY COMPLIANCE:
CE2011/65/EU (RoHS DIRECTIVE)

UNLESS OTHERWISE SPECIFIED, DIMENSIONS ARE IN INCHES [mm] OVERALL CABLE LENGTH TOLERANCE: ≤12 [305] = +1 [25] / -0 >12 [305] ≤60 [1524] = +2 [51] / -0 >60 [1524] ≤120 [3048] = +4 [102] / -0 >120 [3048] ≤300 [7620] = +6 [152] / -0 >300 [7620] = +5% / -0% ALL OTHER DIMENSIONAL TOLERANCES: .X = ± .2 [5.08] .XX = ± .02 [51] .XXX = ±.005 [1.13]	APPROVALS DRAWN BY DOUG PARHAM CHECKED BY TOM CLARK APPROVED BY RON CARRICK	DATE 3/15/2001 3/16/2001 3/20/2001	45 BEECHWOOD DRIVE NORTH ANDOVER, MA 01845		
	CONFIGURATION DETAILS OF UNDIMENSIONED FEATURES MAY VARY			CATEGORY TELECOM/MODULAR	
PROJECTION 	COLOR VARIATIONS MAY OCCUR	SIZE A	FSCM NO. 43321	DWG. NO. EC503-6E	REV. A
SCALE: NONE		CAD FILE: EC503-6E.SLDDRW		SHEET 1 OF 1	