

THE INFORMATION CONTAINED IN THIS DRAWING IS THE SOLE PROPERTY OF L-COM, INC. ANY REPRODUCTIONS IN PART OR WHOLE WITHOUT THE WRITTEN PERMISSION OF L-COM, INC. IS PROHIBITED.

REVISIONS			
REV	DESCRIPTION	DATE	CHANGED BY
A	INITIAL RELEASE	8/12/11	D. CASTRO

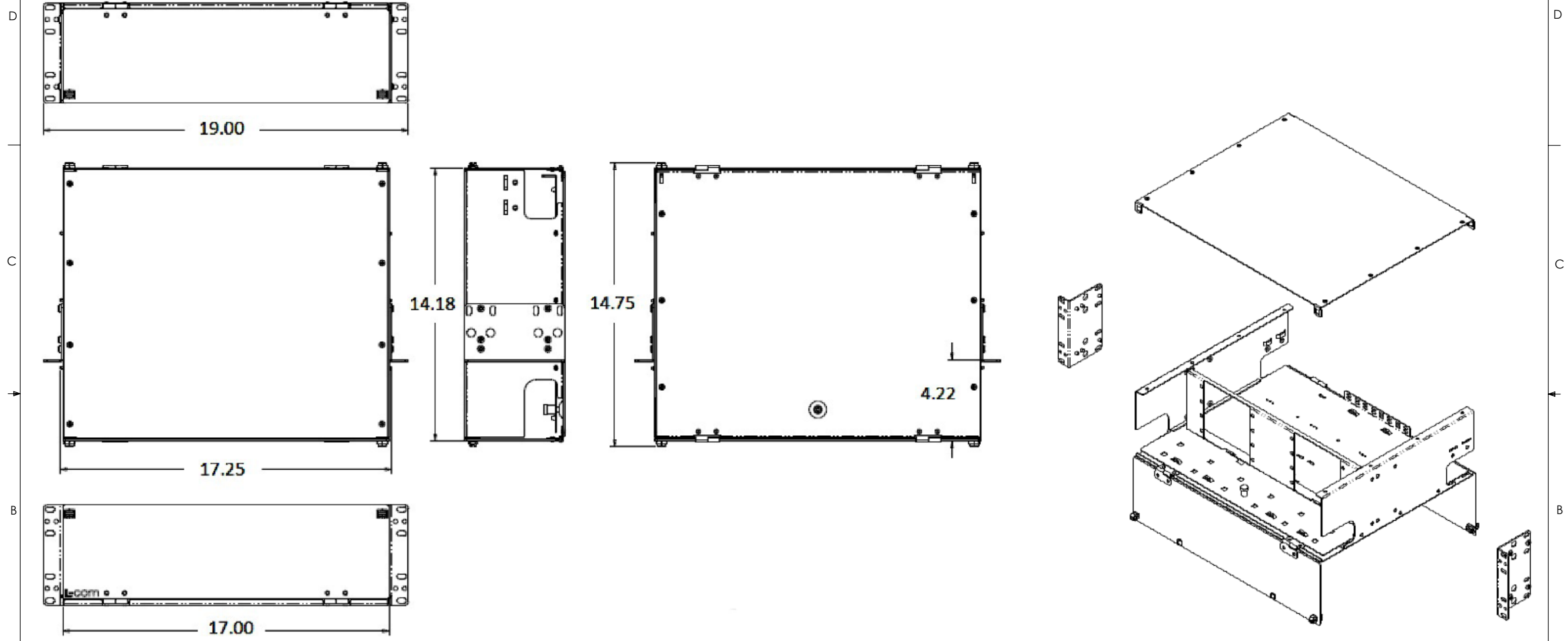

- NOTES:**
1. MATERIAL: 16 GAUGE STEEL.
 2. FINISH: BLACK POWDER COAT.
 3. COMPONENT SHALL BE PACKAGED IN ACCORDANCE WITH L-COM SPEC. PS-0014

UNLESS OTHERWISE SPECIFIED, DIMENSIONS ARE IN INCHES [mm]
 OVERALL CABLE LENGTH TOLERANCE:
 ≤12 [305] = +1 [25] / -0
 >12 [305] ≤60 [1524] = +2[51] / -0
 >60 [1524] ≤120 [3048] = +4 [102] / -0
 >120 [3048] ≤300 [7620] = +6 [152] / -0
 >300 [7620] = +5% / -0%
 ALL OTHER DIMENSIONAL TOLERANCES:
 .X = ±.2
 .XX = ±.02
 .XXX = ±.005

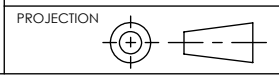

APPROVALS	DATE
DRAWN BY D. CASTRO	8/12/11
CHECKED BY D. FRISIELLO	8/12/11
APPROVED BY M. MARTINEZ	8/12/11

L-com Global Connectivity
 45 BEECHWOOD DRIVE
 NORTH ANDOVER, MA
 01845

CATEGORY RACKS/PANELS	
PRODUCT DESCRIPTION FIBER Encl Rack 3U 48 Port Pnl	
SIZE B	FSCM NO. 43321
DWG. NO. FE-RM3U48PSP	REV. A
SCALE: 1:1	CAD FILE: FE-RM3U48PSP.SLDDRW
SHEET 1 OF 1	