

THE INFORMATION CONTAINED IN THIS DRAWING IS THE SOLE PROPERTY OF L-COM, INC. ANY REPRODUCTION IN PART OR WHOLE WITHOUT THE WRITTEN PERMISSION OF L-COM, INC. IS PROHIBITED.

REVISIONS			
REV	DESCRIPTION	DATE	APPROVED
A	DRAWING REPLACES FOA-311-OD1	9/24/14	D. CASTRO

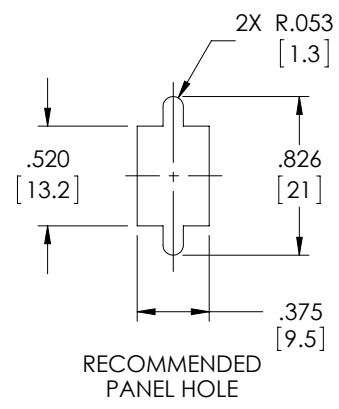
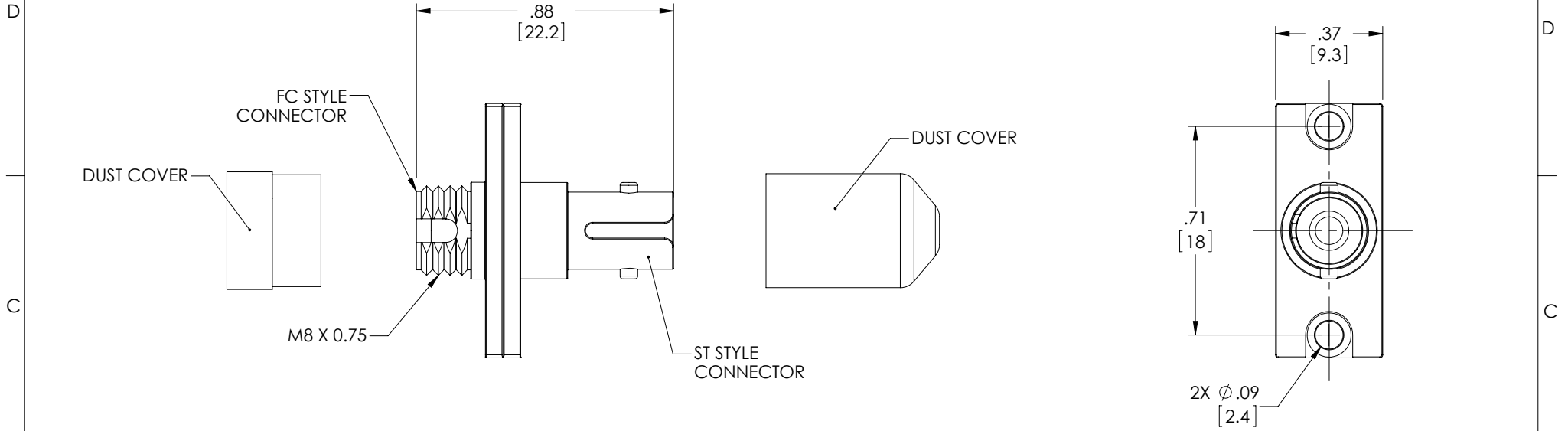

**NOTES:**

**MATERIAL:**  
 SLEEVE: PHOSPHOR BRONZE.  
 ST BODY: ZINC ALLOY.  
 RIVET: COPPER.  
 FC BODY: ZINC ALLOY.  
 ST DUST CAP: PVC.  
 FC DUST CAP: ENGINEERING PLASTIC.

**FINISH:**  
 ST BODY: NICKEL.  
 RIVET: TIN.  
 FC BODY: NICKEL.

**MISCELLANEOUS:**  
 SHIPPED WITH DUST CAPS INSTALLED.  
 COMPONENT SHALL BE INDIVIDUALLY PACKAGED IN ACCORDANCE WITH L-COM SPEC. PS-0031.

**REGULATORY COMPLIANCE:**  
 CE2011/65/EU (ROHS DIRECTIVE)

UNLESS OTHERWISE SPECIFIED, DIMENSIONS ARE IN INCHES [mm] OVERALL CABLE LENGTH TOLERANCE: ≤12 [305] = +1 [25] / -0 >12 [305] ≤60 [1524] = +2 [51] / -0 >60 [1524] ≤120 [3048] = +4 [102] / -0 >120 [3048] ≤300 [7620] = +6 [152] / -0 >300 [7620] = +5% / -0%	APPROVALS	DATE		45 BEECHWOOD DRIVE NORTH ANDOVER, MA 01845
	DRAWN BY C.McCORMICK	12/19/00		CATEGORY
ALL OTHER DIMENSIONAL TOLERANCES: .X = ±.2 [5.08] .XX = ±.02 [51] .XXX = ±.005 [1.27]	CHECKED BY DFP	01/12/01	PRODUCT DESCRIPTION	
	APPROVED BY R.CARRICK	01/12/01	ADPTR, REC/MTL ST-FC SMLPX BRNZ	
PROJECTION	COLOR VARIATIONS MAY OCCUR	SIZE <b>A</b>	FSCM NO. <b>43321</b>	DWG. NO. FOA-311
		SCALE: NONE	CAD FILE: FOA-311.SLDDRW	SHEET 1 OF 1