

THE INFORMATION CONTAINED IN THIS DRAWING IS THE SOLE PROPERTY OF L-COM, INC. ANY REPRODUCTION IN PART OR WHOLE WITHOUT THE WRITTEN PERMISSION OF L-COM, INC. IS PROHIBITED.

RoHS Compliant ✓

REVISIONS			
REV	DESCRIPTION	DATE	APPROVED
A	INITIAL RELEASE	11/4/11	D.GRIFFIN
B	ECN 6818: ADDED COLOR CHART (RED, GREEN ARE NEW), REVISE CUTOUT	5/14/13	D.FRISIELLO

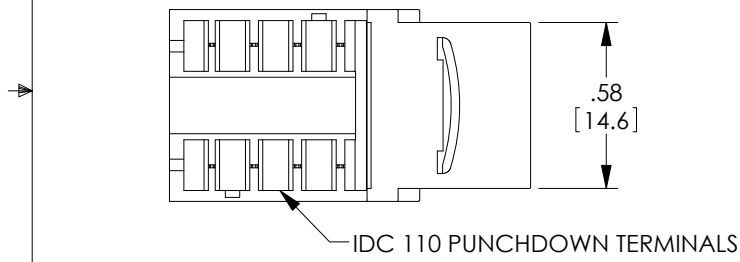
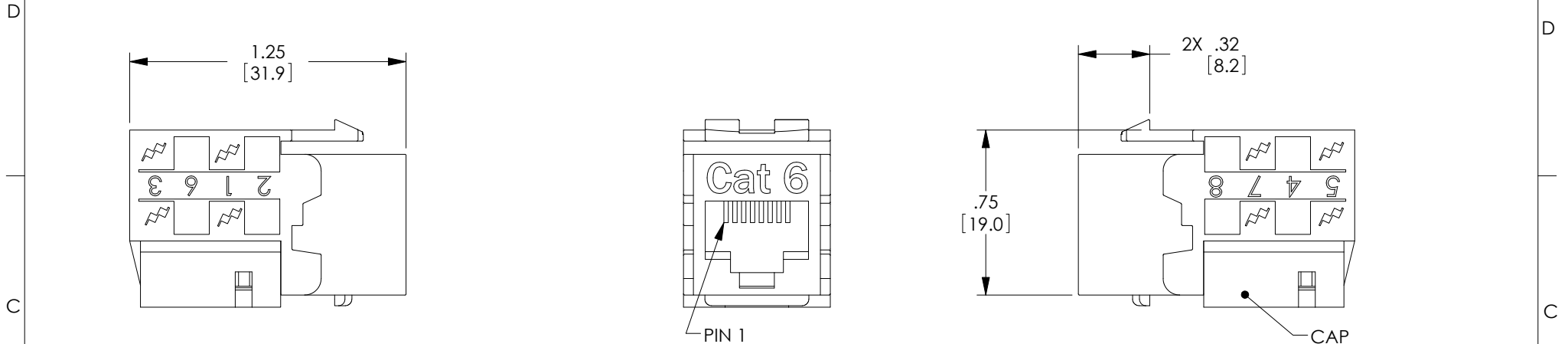

CAP NOT SHOWN IN THIS VIEW FOR CLARITY

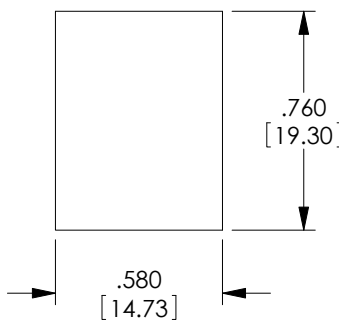

RECOMMENDED PANEL OPENING B

B

CHART A		
MODEL NUMBER	COLOR	PANTONE NUMBER
MJS110C6-BL	BLUE	285C
MJS110C6-BLK	BLACK	-
MJS110C6-GRN	GREEN	340C
MJS110C6-IV	IVORY	4535C
MJS110C6-RED	RED	200C
MJS110C6-WT	WHITE	-
MJS110C6-YL	YELLOW	127C

- NOTE: B
- HOUSING: ABS COLOR: SEE CHART "A"
  - JACK IS CATEGORY 6 RATED
  - COMPLIANT TO MECHANICAL REQUIREMENTS OF TIA-1096.
  - ACCEPTS CONDUCTOR SIZES 24 TO 26 AWG
  - JACK IS INDIVIDUALLY PACKAGED IN ACCORDANCE WITH L-COM SPECIFICATION PS-0031.
  - MAXIMUM PANEL THICKNESS: .060 [1.5]

UNLESS OTHERWISE SPECIFIED, DIMENSIONS ARE IN INCHES [mm] OVERALL CABLE LENGTH TOLERANCE: ≤12 [305] ≤+1 [25] / -0 >12 [305] ≤60 [1524] = +2 [51] / -0 >60 [1524] ≤120 [3048] = +4 [102] / -0 >120 [3048] ≤300 [7620] = +6 [152] / -0 >300 [7620] = +3% / -0%	APPROVALS	DATE		45 BEECHWOOD DRIVE NORTH ANDOVER, MA 01845
	DRAWN BY D. PARHAM	11/03/2011		CATEGORY <b>TELECOM / MODULAR</b>
ALL OTHER DIMENSIONAL TOLERANCES: .X = ± .2 .XX = ± .02 .XXX = ± .005	CHECKED BY D. CASTRO	11/03/2011	<b>JACK CAT6 RJ45/110</b>	
PROJECTION 	APPROVED BY D. GALLAGHER	11/03/2011		
	SIZE <b>A</b>	FSCM NO. <b>43321</b>	DWG. NO. <b>MJS110C6-BL</b>	REV. <b>B</b>
	SCALE: NONE		CAD FILE: MJS110C6-BL.SLDDRW	
				SHEET 1 OF 1