

THE INFORMATION CONTAINED IN THIS DRAWING IS THE SOLE PROPERTY OF L-COM, INC. ANY REPRODUCTION IN PART OR WHOLE WITHOUT THE WRITTEN PERMISSION OF L-COM, INC. IS PROHIBITED.

RoHS Compliant ✓

REVISIONS			
REV	DESCRIPTION	DATE	APPROVED
A	INITIAL RELEASE	9/9/11	D.GRIFFIN
B	ECN 5784: CHANGE BULK CABLE FROM UL1569 TO UL1007	10/18/11	D.FRISIELLO

D

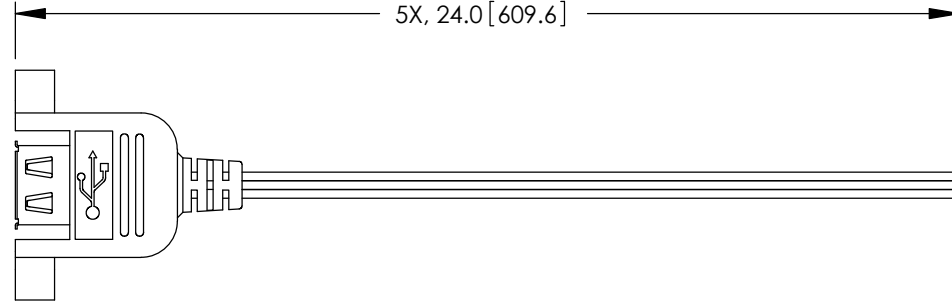
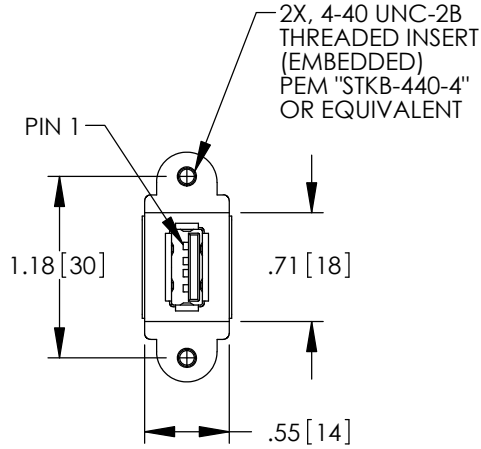

C

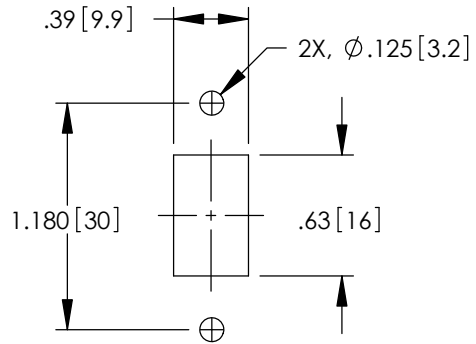

"J1" WIRING DIAGRAM

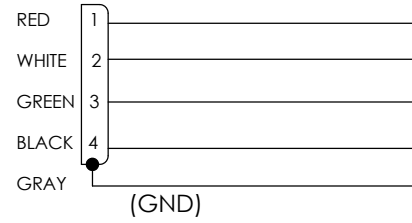

NOTES:

B

MATERIAL:
CONDUCTORS: UL1007, 24AWG STRANDED TINNED COPPER.
MOLDED HOOD: PVC, GRAY (PANTONE 424C)

FINISH:
USB CONTACT FINISH 30 μ IN GOLD OVER 50 μ IN NICKEL PLATE.

MISCELLANEOUS:
CABLE ASSEMBLY SHALL BE TESTED FOR CONTINUITY.
INCLUDE MOUNTING HARDWARE 2X #4-40 X .38 LG. PHILLIPS PAN HD SCREW.
CABLE ASSEMBLY SHALL BE INDIVIDUALLY PACKAGED IN ACCORDANCE WITH L-COM SPECIFICATION PS-0031.

A

UNLESS OTHERWISE SPECIFIED, DIMENSIONS ARE IN INCHES [mm] OVERALL CABLE LENGTH TOLERANCE: ≤ 12 [305] = +1 [25] / -0 >12 [305] ≤ 60 [1524] = +2 [51] / -0 >60 [1524] ≤ 120 [3048] = +4 [102] / -0 >120 [3048] ≤ 300 [7620] = +6 [152] / -0 >300 [7620] = +3% / -0% ALL OTHER DIMENSIONAL TOLERANCES: .X = \pm .2 .XX = \pm .02 .XXX = \pm .005 PROJECTION 	APPROVALS D.FRISIELLO CHECKED BY C.BRAN APPROVED BY S.SMITH	DATE 9/8/11 9/8/11 9/8/11	 45 BEECHWOOD DRIVE NORTH ANDOVER, MA 01845	
	CONFIGURATION DETAILS OF UNDIMENSIONED FEATURES MAY VARY		CATEGORY USB	
	COLOR VARIATIONS MAY OCCUR		PRODUCT DESCRIPTION CA USB-A PNL/WIRE LEADS	SHEET 1 OF 1
	SCALE: NONE	FSCM NO. A 43321	DWG. NO. UPMA-LEADS	REV. B

A