

THE INFORMATION CONTAINED IN THIS DRAWING IS THE SOLE PROPERTY OF L-COM, INC. ANY REPRODUCTION IN PART OR WHOLE WITHOUT THE WRITTEN PERMISSION OF L-COM, INC. IS PROHIBITED.

REVISIONS			
REV	DESCRIPTION	DATE	APPROVED
A	REV A DRAWING RELEASED	10/26/2018	JYOU

Notes:

Electrical:
 Impedance: 75Ω
 Frequency Range: 0~12 GHz.
 Voltage Rating: ≥500 V rms.
 (depending on cable)
 INsulator Resistance: ≥5 GΩ
 Dielectric Withstanding Voltage:
 1500V rms.
 Contact Resistance:
 Center Contact ≤1.5 mΩ.
 Outer Contact ≤1 mΩ.
 VSWR: < 1.2(0~12 GHz)

Environmental:
 Temperature Range: -65a to 165a
 Corrosion (Salt Spray): **MIL-STD-202**, Method 101, Cond. C
 Thermal Shock: **MIL-STD-202**, Method 107, Cond. B
 Mechanical: **MIL-STD-202**, Method 213, Cond. G
 Vibration: **MIL-STD-202**, Method 204, Cond. B

PACKAGING:
 CONNECTOR SHALL BE INDIVIDUALLY PACKAGED IN ACCORDANCE WITH L-COM SPECIFICATION PS-0031.

REGULATORY COMPLIANCE:
 CE2011/65/EU(RoHS DIRECTIVE)

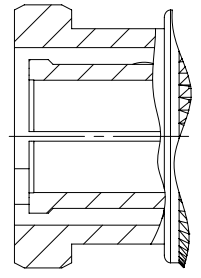
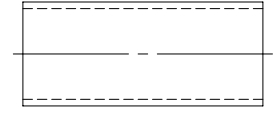
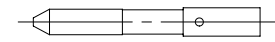
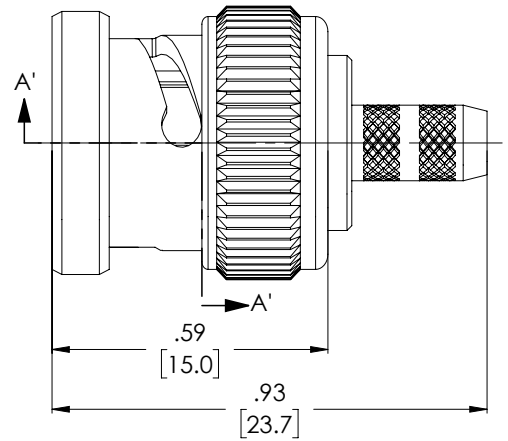

Section A'-A' 75Ω

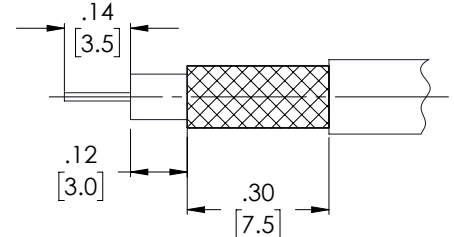

Recommended Cable Stripping Dimensions

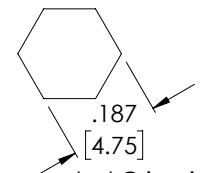
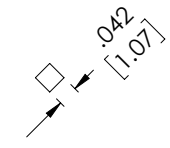

Recommended Crimping Dimensions for Inner Contact Recommended Crimping Dimensions for Ferrule

ITEM	Description	Material	Finish
5	Ferrule	Brass	NICKEL PLATE
4	Inner Contact	Brass	NICKEL/GOLD PLATE
3	insulator	PTFE	None
2	Body	Brass	NICKEL PLATE
1	Shell	Brass	NICKEL PLATE

UNLESS OTHERWISE SPECIFIED, DIMENSIONS ARE IN INCHES [mm]

OVERALL CABLE LENGTH TOLERANCE:
 ≤12 [305] = +1 [25] / -0
 >12 [305] ≤60 [1524] = +2 [51] / -0
 >60 [1524] ≤120 [3048] = +4 [102] / -0
 >120 [3048] ≤300 [7620] = +6 [152] / -0
 >300 [7620] = +5% / -0%

ALL OTHER DIMENSIONAL TOLERANCES:
 .X = ± .2 [5.08]
 .XX = ± .02 [5.1]
 .XXX = ±.005 [1.3]

PROJECTION

APPROVALS	DATE
DRAWN BY JYOU	09/14/2018
CHECKED BY BZHANG	09/14/2018
APPROVED BY SPAN	09/14/2018

L-com Global Connectivity
 50 HIGH STREET
 NORTH ANDOVER, MA
 01845

CATEGORY: Coaxial

PRODUCT DESCRIPTION: BNC S/T Plug, Dual Crimp Type for Belden 1855 ENH Cable (75Ω)

SIZE A	FSCM NO. 43321	DWG. NO. V7C00010	REV. A
------------------	--------------------------	----------------------	------------------

SCALE: NONE CAD FILE: V7C00010.SLDDRW SHEET 1 OF 1