

THE INFORMATION CONTAINED IN THIS DRAWING IS THE SOLE PROPERTY OF L-COM, INC. ANY REPRODUCTION IN PART OR WHOLE WITHOUT THE WRITTEN PERMISSION OF L-COM, INC. IS PROHIBITED.

REVISIONS			
REV	DESCRIPTION	DATE	APPROVED
A	INITIAL RELEASE	6/29/12	D.GRIFFIN

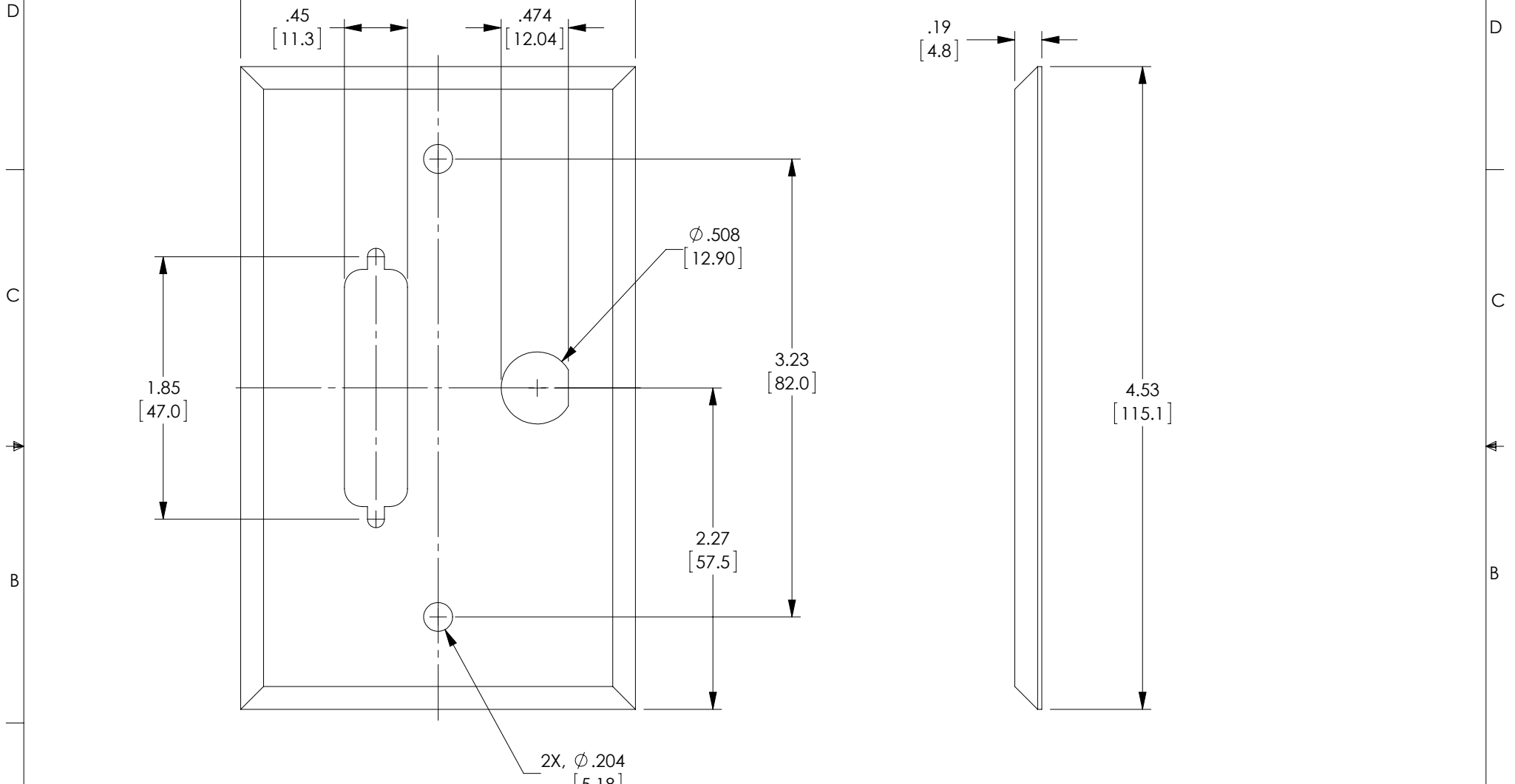

NOTES:
 MATERIAL: .036" (20 GAUGE) STAINLESS STEEL.
 ALL DIMENSIONS ARE FOR REFERENCE ONLY.
 (2) #6-32 UNC-2A x 3/4" LG OVAL HEAD SCREWS INCLUDED.
 COMPONENT SHALL BE INDIVIDUALLY PACKAGED IN ACCORDANCE WITH L-COM SPECIFICATION PS-0031.

UNLESS OTHERWISE SPECIFIED, DIMENSIONS ARE IN INCHES [mm] OVERALL CABLE LENGTH TOLERANCE: ≤12 [305] = +1 [25] / -0 >12 [305] ≤60 [1524] = +2 [51] / -0 >60 [1524] ≤120 [3048] = +4 [102] / -0 >120 [3048] ≤300 [7620] = +6 [152] / -0 >300 [7620] = +3% / -0% ALL OTHER DIMENSIONAL TOLERANCES: .X = ±.2 .XX = ±.02 .XXX = ±.005	APPROVALS DRAWN BY D.FRISIELLO	DATE 6/29/12		45 BEECHWOOD DRIVE NORTH ANDOVER, MA 01845
	CHECKED BY D.DESJARDIN	DATE 6/29/12		CATEGORY WALL PLATES
PROJECTION 	CONFIGURATION DETAILS OF UNDIMENSIONED FEATURES MAY VARY	COLOR VARIATIONS MAY OCCUR	PRODUCT DESCRIPTION WALL PLATE SS W/1D-SUB/.5 DIA	
SIZE A	FSCM NO. 43321	DWG. NO. WPD3	REV. A	
SCALE: NONE		CAD FILE: WPD3.SLDRW		SHEET 1 OF 1