

THE INFORMATION CONTAINED IN THIS DRAWING IS THE SOLE PROPERTY OF L-COM, INC. ANY REPRODUCTION IN PART OR WHOLE WITHOUT THE WRITTEN PERMISSION OF L-COM, INC. IS PROHIBITED.

REVISIONS			
REV	DESCRIPTION	DATE	APPROVED
A	DRAWING REPLACES HPC403-OD1	10/7/14	D.FRISIELLO
B	ECN 7730 UPDATE TO CURRENT VENDOR SPECS	01/12/15	B.PUCHASKI

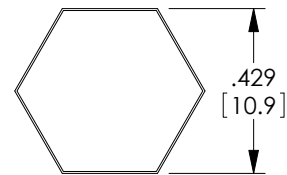

RECOMMENDED FERRULE CRIMP SIZE
*CENTER PIN: SOLDER

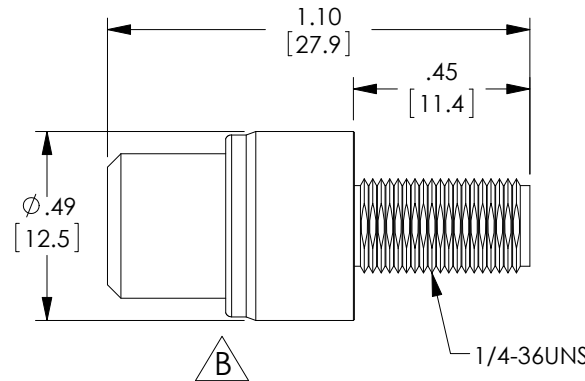
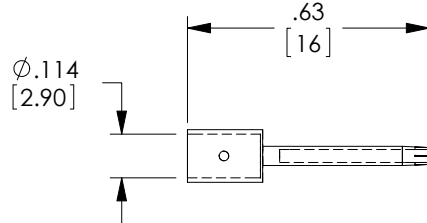
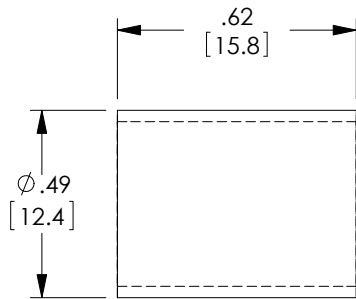
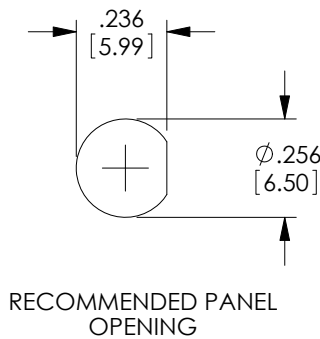

RECOMMENDED PANEL OPENING

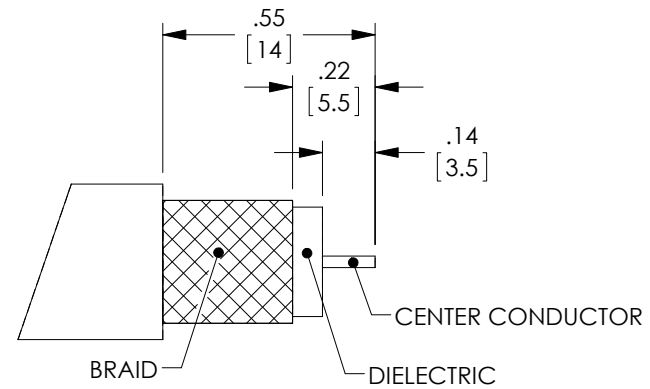

RECOMMENDED CABLE STRIPPING DIMENSIONS

NOTES:

MATERIALS:

- BODY: BRASS
- FERRULE: BRASS
- PIN: P. BRONZE
- INSULATOR: PTFE



FINISH:

- BODY: NICKEL PLATE, 120μ INCHES MIN.
- FERRULE: NICKEL PLATE, 120μ INCHES MIN.
- PIN: GOLD PLATE, 5μ INCHES MIN.

ALL DIMENSIONS ARE FOR REFERENCE ONLY.

APPLICATION: LMR400 CABLE ASSEMBLIES.
IMPEDANCE: 50 OHM

CONNECTOR SHALL BE INDIVIDUALLY PACKAGED IN ACCORDANCE WITH L-COM SPECIFICATION PS-0031.

REGULATORY COMPLIANCE:

CE2011/65/EU (RoHS DIRECTIVE)

UNLESS OTHERWISE SPECIFIED, DIMENSIONS ARE IN INCHES [mm] OVERALL CABLE LENGTH TOLERANCE: ≤12 [305] = +1 [25] / -0 >12 [305] ≤60 [1524] = +2 [51] / -0 >60 [1524] ≤120 [3048] = +4 [102] / -0 >120 [3048] ≤300 [7620] = +6 [152] / -0 >300 [7620] = +5% / -0% ALL OTHER DIMENSIONAL TOLERANCES: .X = ± .2 [5.08] .XX = ± .02 [51] .XXX = ±.005 [1.27]	APPROVALS DRAWN BY C.MCCORMICK	DATE 12/04/2004		45 BEECHWOOD DRIVE NORTH ANDOVER, MA 01845	
	CHECKED BY D.PARHAM	12/04/2004		CATEGORY COAXIAL	
	APPROVED BY R.CARRICK	12/04/2004	PRODUCT DESCRIPTION CONN SMA F LMR400 CRIMP	SIZE A	FSCM NO. 43321
	PROJECTION 	COLOR VARIATIONS MAY OCCUR	DWG. NO. HPC403	REV. B	SCALE: NONE CAD FILE: HPC403.SLDDRW SHEET 1 OF 1